

EN Operating and installation instructions CKASE

Cooktop extractor system

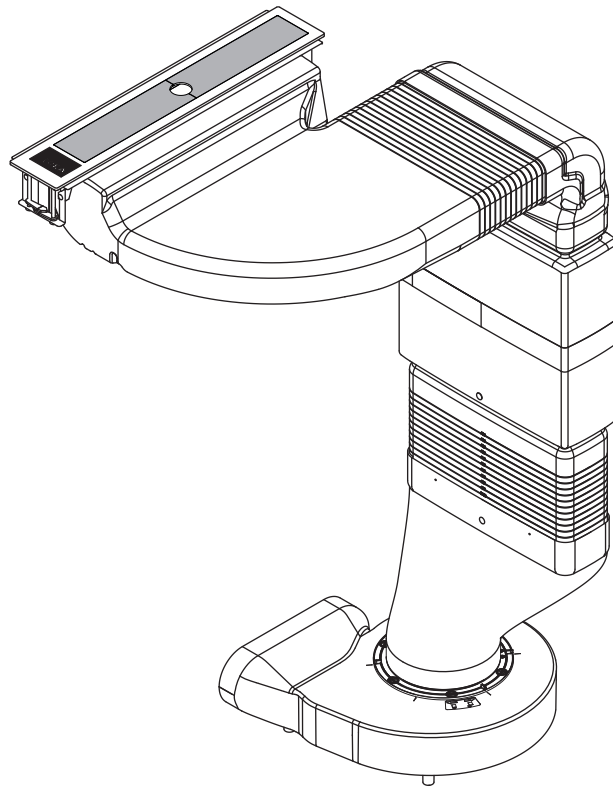

CKASEUMEN-002

Operating and installation instructions:

Original

Translation

Manufacturer

BORA Vertriebs GmbH & Co KG
Prof.-Dr.-Anton-Kathrein-Straße 3
6342 Niederndorf
Austria

Contact
T +43 (0) 5373/62250-0
mail@bora.com
www.bora.com

The distribution and duplication of this document, as well as the use and disclosure of its contents are prohibited unless expressly authorised.

© BORA Vertriebs GmbH & Co KG

All rights reserved.

Table of Contents

1	General	4	9	Troubleshooting	28
2	Safety	6	10	Decommissioning, disassembly and disposal	29
2.1	General safety precautions	6	10.1	Decommissioning	29
2.2	Safety instructions, assembly.....	7	10.2	Disassembly	29
2.3	Safety instructions, disassembly and disposal	8	10.3	Disposing of the product in an environmentally friendly way	29
2.4	Safety instructions, spare parts	8			
2.5	Use as intended	8			
3	Technical data	10	11	Warranty, service and spare parts	30
4	Energy label	11	11.1	Warranty.....	30
5	Device description	12	11.2	Service	30
5.1	Structure	12	11.3	Spare parts.....	30
5.2	Operating panel and operating principle	12	12	Notes	31
5.3	Functional principle of the cooktop extractor ...	13			
5.3.1	Freely adjustable power control.....	13			
5.3.2	Automatic after-run	13			
5.3.3	Filter service display.....	13			
5.3.4	Interface communication.....	13			
5.3.5	Safety shut-down	13			
6	Installation	14			
6.1	Checking the scope of delivery	14			
6.2	Tool and aids.....	14			
6.3	Assembly instructions	14			
6.3.1	Safety clearances.....	14			
6.4	Cut-out dimensions	14			
6.5	Installing the extraction system	16			
6.5.1	Installing the cooktop extractor	17			
6.5.2	Preparing to install the substructure module, silence module and plinth fan	18			
6.5.3	Installation – standard set-up.....	19			
6.6	Establishing the power connection and communication.....	21			
6.7	Connecting external switch contacts	21			
6.8	Handover to user.....	23			
7	Operation	24			
7.1	Operating the cooktop extractor	24			
7.1.1	Opening the cover plates	24			
7.1.2	Adjusting the power level.....	24			
7.1.3	Automatic after-run	24			
7.2	Pay attention to the filter service display	25			
7.2.1	Closing the cover plates.....	25			
8	Cleaning and Maintenance	26			
8.1	Cleaning agents.....	26			
8.2	Cleaning the cooktop extractor	26			
8.2.1	Removing the cover plates and the stainless steel grease filter	26			
8.2.2	Cleaning the cover plates and the stainless steel grease filter	26			
8.2.3	Installing the cover plates and stainless steel grease filter	27			
8.3	Replacing the activated charcoal filter	27			

1 General

Target group

These operating and assembly instructions are intended for the following target groups:

Target group	Requirements
Users	The Device may be used by children from the age of 8 as well as by people with limited physical, sensory or mental capabilities or a lack of experience and/or knowledge, provided they are supervised, have been instructed in the safe use of the device and have understood the dangers involved. Children must be supervised. All safety and warning information and handling instructions in the operating manual must be followed.
Ambitious DIYers	Ambitious DIYers may carry out all the necessary carpentry and assembly work themselves providing that they have the necessary skills and knowledge. They must not connect the current and gas themselves.
Assembly expert	The assembly expert must carry out all the necessary carpentry and assembly work taking existing regulations into account. The current and gas connections must be approved for the system in use by a certified electrician or gas engineer before use.
Electrical expert	The electrical connection must only be executed by a certified electrician. He/she also assumes responsibility for the proper electrical installation and commissioning.
Expert gas connection	The gas connection must only be implemented by a certified gas engineer. He/she also assumes responsibility for the proper gas installation and commissioning.

Tab. 1.1 Target groups

INFO BORA Holding GmbH, BORA Vertriebs GmbH & Co KG, BORA APAC Pty Ltd and BORA Lüftungstechnik GmbH - hereinafter referred to as BORA - shall not assume any liability for damage caused by non-compliance with these documents nor by improper assembly! The electricity and gas connections must be implemented by a certified engineer. Assembly must only take place in compliance with the applicable norms, regulations and laws. All safety and warning information and handling instructions in the operating and assembly instructions must be followed.

Validity of the operating and assembly instructions

This manual is valid for several versions of the device. For this reason, it is possible that individual features are described in the manual that do not apply to your device.

Other applicable documents

Additional documents are valid as well as these operating and assembly instructions, and likewise need to be observed.

Please observe all documents included in the scope of delivery.

INFO BORA cannot assume any liability for damage caused by non-compliance with these documents!

Guidelines

These devices meet the following EC guidelines:

2014/30/EC EMC Directive
 2014/35/EC Low-Voltage Directive
 2009/125/EC Ecological Design Directive
 2010/30/EC Energy label Directive
 2011/65/EC RoHS Directive
 2012/19/EC WEEE Directive

Depiction of information

We used standard formatting, numbering, symbols, safety instructions, terms and abbreviations so that you can work quickly and safely when using this manual.

Instructions are marked with an arrow.

► Always perform all instructions in the prescribed order. **Enumerations** are indicated with a square bullet point at the start of the line.

■ Enumeration 1
 ■ Enumeration 2

INFO Information notes point to special features that must be taken into account.

Safety and warning instructions

The safety and warning instructions in this manual are emphasised with symbols and signal words.



Safety and warning instructions are structured as follows:

WARNING SYMBOL AND SIGNAL WORD!
Type and source of the danger
 Results of non-compliance

► Measures to minimise risk

Please note:

- The warning symbol draws your attention to the risk.
- The signal word indicates the severity of that risk.

Warning symbol	Signal word	Risk
	Danger	Indicates an immediate, hazardous situation which causes death or serious injury if not respected.
	Warning	Indicates a potentially hazardous situation which can cause death or serious injury if not respected.
	Caution	Indicates a possible hazardous situation which can cause minor injury if not respected.
–	Caution	Indicates a situation which can cause minor injury if not respected.

Tab. 1.2 Meaning of the warning symbols and signal words

2 Safety

2.1 General safety precautions

INFO The product complies with the mandatory safety provisions. The user is responsible for cleaning, care and safe use of the device. Any improper use may lead to personal injury and property damage.

- This operating and installation instructions contain important information concerning assembly and operation. It protects you from injury and prevents damage to the product. You can find contact data to get further information and answers to questions about the use of the product on the last page of this operating and installation instructions.
- The term “device” is used to refer to cooktop, cooktop extractor or cooktop with integrated cooktop extractor.
 - ▶ Read this operating and installation instructions in full before you assemble the device and start to use it.
 - ▶ Always keep these operating and installation instructions to hand so it is available when needed.
 - ▶ After selling the device, pass on the operating and installation manual to the new owner.
 - ▶ Carry out all work with great care and attention.
 - ▶ Check the device for visible damage after unpacking.
 - ▶ Do not install a damaged device.
 - ▶ Do not use the device until installation is complete. Only in this way a safe operation can be guaranteed.
 - ▶ Make sure contact with hot cooking surfaces is not possible.
 - ▶ Avoid over-cooking.
 - ▶ Do not, under any circumstances, operate the cooktop extractor with other cooktops.
 - ▶ Turn the device off after use.
 - ▶ Keep pets away from the device.

Recirculated air mode

INFO Every time the device is used for cooking, supplementary moisture is released into the room air.

INFO In the recirculated air mode, only a small amount of moisture is removed from the cooking vapours.

- ▶ Make sure that the room is sufficiently ventilated to the outside air in the recirculated air mode, e.g. through an open window.
- ▶ Ensure a normal and comfortable indoor climate (45-60% humidity), e.g. through natural ventilation openings or domestic ventilation systems.
- ▶ Set the cooktop extractor to a low setting for about 15 minutes or activate the automatic after-run after every use in the recirculated air mode.

Cooktop extractor



DANGER!

Danger to life caused by smoke poisoning!

Combustion gases arise when running a fireplace that depends on the air in the room.

If you operate the cooktop extractor with a fireplace that depends on the air in the room at the same time, poisonous combustion gases (carbon monoxide) may be drawn from the chimney or extraction duct into the living room.

- ▶ Make sure that there is always enough air supply.



DANGER!

Risk of fire through flambéing!

While in operation, the cooktop extractor draws off cooking fat. When flambéing food, the cooking fat can catch fire.

- ▶ Clean the cooktop extractor at regular intervals.
- ▶ Do not carry out any work involving an open flame when the cooktop extractor is switched on.



DANGER!
Danger of fire due to grease deposits!

By failing to clean the stainless steel grease filter at regular intervals, increased amounts of grease may accumulate in it. This increases the risk of fire.

- ▶ Clean or replace the filters at regular intervals.



WARNING!
Risk of injury due to moving fan wheel!

There is a risk of injury if the fan wheel turns.

- ▶ Only install the device with the power disconnected.
- ▶ Connect both sides of the fan to the duct system before commissioning.
- ▶ Ensure that the inlet nozzle is locked before the device is commissioned for the first time.



CAUTION!
Touchable parts may become hot!

The cooktop extractor and its touchable parts are hot when the cooking zone is switched on and during the cooling phase.

- ▶ Do not place any items on the cooktop.
- ▶ Please use suitable tools (pot holders, oven gloves).

CAUTION!
Damage caused by objects or paper being sucked in!

Small and light objects such as cleaning wipes made of fabrics or paper can be sucked into the cooktop extractor. As a result, the fan can be damaged or the fan output can be impaired.

- ▶ Do not store any objects or paper on the cooktop extractor.

CAUTION!
Damage caused by fat or dirt deposits!

Fat or dirt deposits can impair the functioning of the cooktop extractor.

- ▶ Never use the cooktop extractor without a stainless steel grease filter.

2.2 Safety instructions, assembly

Installation and assembly of the device may only be carried out by trained personnel who are familiar with and comply with common national regulations and supplementary regulations of the local utility companies.

Work on electrical parts must only be carried out by trained electrical personnel.

The electrical safety of the device is only guaranteed if it is connected to a properly installed protective conductor system. Make sure that these basic safety precautions have been taken.

Cooktop extractor



DANGER!
Risk of poisoning caused by combustion gases!

When the cooktop extractor is used for exhaust operation, it draws in air from the room it is installed in and from neighbouring rooms. Without sufficient air, negative pressure will occur. Toxic gases could be drawn out of the chimney or extraction ducting on a fireplace that depends on the room air and back into the room.

- ▶ Make sure there is always enough air supply.
- ▶ Use technical safety measures (e.g. window contact switch, low pressure warning device) and have them approved by a qualified expert (certified chimney-sweep).

**DANGER!****Risk of electric shock!**

The electronic unit can contain residual charge and cause an electric shock.

- ▶ Do not touch exposed contacts on the electronic unit.

**DANGER!****Risk of electric shock!**

Incorrect stripping of the connection cable to external switching devices results in a risk of electric shock. Ensure that the connection cable is secured with the strain relief clamp within the universal control unit. Ensure that the stated stripping lengths are adhered to.

- ▶ Check the device for visible damages before installing it.
- ▶ Do not install a damaged device.
- A damaged device may put your safety at risk!

Repair and maintenance work may only be carried out by specialists authorised by the manufacturer.

2.3 Safety instructions, disassembly and disposal

Disassembly of the device may only be carried out by trained personnel who are familiar with and comply with common national regulations and supplementary regulations of the local utility companies.

Work on electrical parts may only be carried out by trained electrical personnel.

**DANGER!****Danger of electric shock!**

Disconnecting the device incorrectly from the mains poses a risk of electric shock.

- ▶ Safely disconnect the device from the mains using miniature or automatic circuit breakers, fuses or contactors.
- ▶ Use a suitable measuring device to ensure that the device is de-energised.

**DANGER!****Risk of suffocation!**

Parts of the packaging (e.g. films, polystyrene) can be fatal to children.

- ▶ Store packaging materials away from the reach of children.
- ▶ Dispose of packaging correctly and promptly.

2.4 Safety instructions, spare parts

**WARNING!****Risk of injury and damage to property!**

Incorrect parts can lead to injury to persons or damage to device! Modifications, attachment parts or conversions to device can impair safety.

- ▶ Only use original spare parts when carrying out repairs.

2.5 Use as intended

The device is solely intended for preparing food in private households.

This device is not designed for:

- use outdoors
- installation in vehicles
- heating the room
- use in non-fixed installation sites (e.g. on ships)
- use with an external timer or separate remote control system.

Not using the device as described in this operating and assembly manual is considered not using the device as intended, as is using it beyond the purpose described here.

BORA shall not assume any liability for damages caused by improper use or incorrect operation.

All misuse is prohibited!

INFO BORA Holding GmbH,
BORA Vertriebs GmbH & Co KG,
BORA APAC Pty Ltd and
BORA Lüftungstechnik GmbH shall
not assume any liability for damage
arising from non-adherence to the
safety and warning instructions.

3 Technical data

Parameter	Value
Supply voltage	220 - 240 V
Frequency	50/60 Hz
Power consumption	170 W
Dimensions (width x depth x height)	90 x 515 x 140 mm
Weight (incl. accessories/packaging)	11.0 kg
Extractor	
Power levels	1 - 5
Plinth fan	
Maximum flow volume	608.8 m ³ /h
Maximum pressure	597 Pa
Dimensions (width x depth x height)	370 x 358 x 100 mm
Exhaust opening dimensions (width x depth x height)	222 x 40 x 89 mm
Duct system	
Total height adjustable from - to	900 - 1050 mm
Total depth adjustable from - to	560 - 710 mm

Tab. 3.1 Technical data

Device dimensions



Abb. 3.1 Device dimensions

4 Energy label

Product description		
Classic cooktop extractor system with ULS plinth fan	CKASE	
Operating mode	Exhaust air	
Energy consumption	Value	EN standard
Annual energy consumption (AEC_{hood})	24 kWh/a	61591
Energy efficiency class	A++	61591
Flow volume		
Fluid dynamic efficiency (FDE_{hood})	38.4	61591
Fluid dynamic efficiency class	A	61591
Lighting		
Lighting efficiency (LE_{hood})	* lx/Watt	*
Lighting efficiency class	*	*
Grease filtering		
Level 5 maximum (GFE_{hood})	47%	61591
Class level 5 normal	F	61591
Flow volume		
Air flow level 1 minimum	224 m ³ /h	61591
Air flow level 5 maximum (Q_{max})	609 m ³ /h	61591
Sound power level		
Level 1 minimum	46 dB(A)	60704-2-13
Level 5 maximum	67 dB(A)	60704-2-13
Sound pressure level (additional details)		
Level 1 minimum	33 dB(A)	**
Level 5 maximum	55 dB(A)	**
Details according to 66/2014		
Power consumption in off mode (P_o)	< 0.5 W	61591
Time increase factor	0.6	61591
Energy efficiency index (EEl_{hood})	31.7	61591
Air flow rate at the best efficiency point (Q_{BEP})	280.8 m ³ /h	61591
Pressure at the best efficiency point (P_{BEP})	536 Pa	61591
Electric power input at the best efficiency point (W_{BEP})	109 W	61591

Tab. 4.1 Energy label information

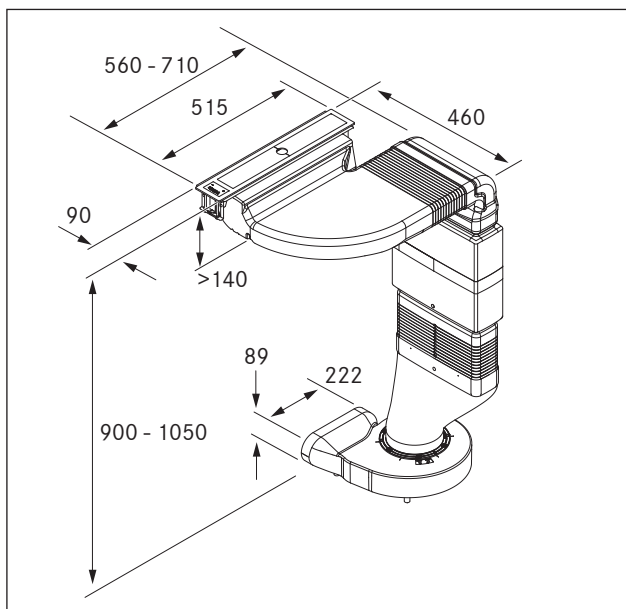
* This specification is not applicable for this product.

** The sound pressure level has been determined from a distance of 1 m (distance-dependent level recording) on the basis of the sound power level established in EN 60704-2-13.

5 Device description

Observe all safety and warning information during operation (see the Safety section).

The cooktop extractor system has the following features:

- Touch-operated power control
- Electronic power control (5 power levels)
- Automatic after-run
- Filter service display
- Interface communication
- Safety shut-down
- Integrated silencer (silence module)
- Rubberised device feet

Depending on the model you purchased, the cooktop extractor system can be operated as an exhaust air or an recirculating air version.



Exhaust mode

The air extracted from the cooktop is cleaned by the stainless steel grease filter and released outside through a duct system.

The exhaust air must not be expelled into:

- a smoke or exhaust gas flue that is in operation
- a shaft used for the aeration of rooms where fireplaces are installed.

If the exhaust air is to be directed into a smoke or exhaust gas flue that is not in use, the installation must be checked and approved by the responsible heating engineer.



Recirculation mode

The air suctioned away by the cooktop is purified by the grease filter and an activated charcoal filter and fed back into the room in which the appliance is installed.

An activated charcoal filter must be used to prevent odours in recirculation mode. For hygiene and health reasons, the activated charcoal filter must be replaced at the recommended intervals (see the Cleaning and maintenance section).

INFO In recirculation mode, ensure sufficient ventilation and aeration to discharge humidity.

5.1 Structure



Abb. 5.1 Cooktop extractor system

- [1] Stainless steel grease filter
- [2] Substructure module
- [3] Silence module
- [4] Curved transition piece
- [5] Universal plinth fan
- [6] Classic control unit
- [7] Straight transition piece (optional)
- [8] Touchscreen operating panel with fan display
- [9] Cooktop extractor cover plate
- [10] Cooktop extractor frame
- [11] Protective grid (not shown)

5.2 Operating panel and operating principle



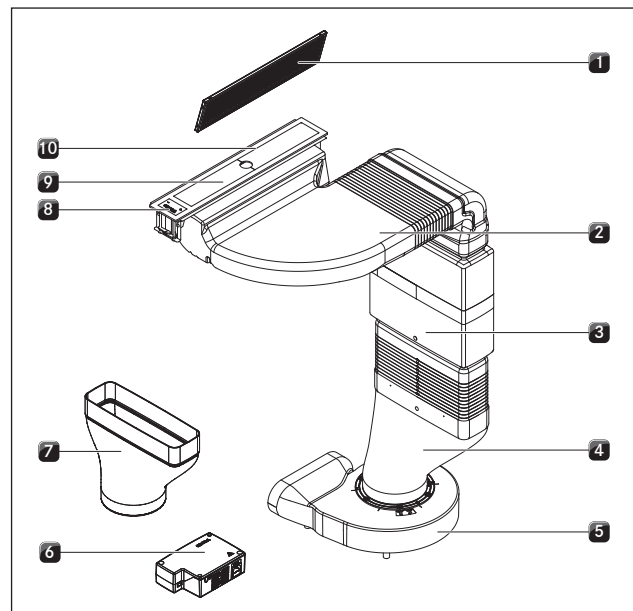

Abb. 5.2 Touchscreen operating panel with fan display

- [1] Minus button
- [2] Fan display
- [3] Plus button

Unit	Display	Meaning
Fan display		Fan off
	1-5	Power levels
	E	Interface display
	F	Filter service display
	n	Automatic after-run

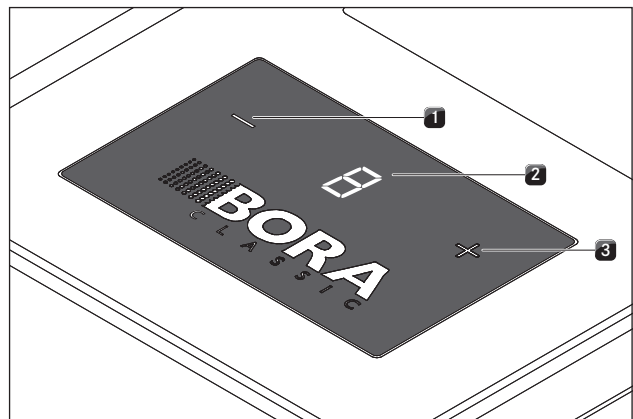
Tab. 5.1 Display meanings



Touch control

The operating panel is fitted with electronic sensor buttons and display panels. The sensor buttons respond to finger contact.

The device is operated by touching the corresponding sensor button with your finger. Keep your finger pressed on the sensor button until the display changes as desired.

5.3 Functional principle of the cooktop extractor

5.3.1 Freely adjustable power control

The power levels are controlled using the  and  buttons on the touchscreen operating panel.

5.3.2 Automatic after-run

The cooktop extractor continues to run at a lower level n and switches off automatically after 20 minutes.

5.3.3 Filter service display

The filter service display becomes active after the cooktop extractor has operated for 200 hours. The activated charcoal filter has reached the end of its service life (with recirculation only) and the stainless steel grease filter needs to be thoroughly cleaned.

- A flashing F is displayed in the filter service display.
- The display goes out as soon as a power level has been selected.

5.3.4 Interface communication

The internal interface can be used for extended control options. This has a Home-In and a Home-Out contact (see the Installation section).

- The Home-In contact can be used for the incoming signal from external switch devices (e.g. window contact switch).
- The Home-Out contact can be used to control external installations.

5.3.5 Safety shut-down

The cooktop extractor switches off automatically if no buttons are pressed for 120 minutes.

6 Installation

- Observe all safety and warning information (see the Safety section).

INFO The device must not be installed above cooling devices, dishwashers, stoves, ovens, washing machines or dryers.

INFO The contact surfaces of the worktops and wall sealing strips must be made of a heat-resistant material (up to approx. 100 °C).

INFO Worktop cut-outs must be moisture-sealed using suitable means or, where necessary, fitted with a thermal insulator.

INFO If the induction glass ceramic wok is used, the groove dimensions must be increased to 7 mm for flush installation!

6.1 Checking the scope of delivery

Name	Quantity
Cover plates	2
Operating and installation instructions	1
Sealing tape for the cooktop extractor	1
Stainless steel grease filter	1
Height adjustment plate set	1
Cooktop extractor frame	1
CAT 5 communication cable	1
Lenshead screws	4
Power supply cable	1
Protective grid	1
Silence module	1
UDB Universal sealing tape	1
ULS Universal plinth fan	1
CSEE Classic control unit	1
Substructure module	1
Curved transition piece	1
Straight transition piece	1

Tab. 6.1 Scope of delivery

- Check the scope of delivery for damage and make sure Tab. 6.1 complete (see tab. 6.1).
- If there are any missing or damaged parts, please notify BORA After Sales Service.
- Do not under any circumstances install parts which are damaged.
- Dispose of transport packaging in the proper manner (see the Decommissioning, disassembly and disposal section).

6.2 Tool and aids

The following tools are required to correctly install the cooktop extractor:

- Pencil
- Tape measure
- Phillips screwdriver Z2
- Black, heat-resistant silicone sealant
- Fine saw

6.3 Assembly instructions

6.3.1 Safety clearances



Abb. 6.1 Recommended minimum clearances

- Maintain the following safety clearances:

- [1] Rear minimum clearance of 50 mm between the worktop cut-out and the rear corner of the worktop.
- [2] Minimum clearance of 50 mm from the left and right of the worktop cut-out to the adjacent cabinet or wall. For ergonomic reasons and to ensure efficient cooktop extraction, a minimum clearance of 300 mm is recommended.
- [3] Minimum clearance of 600 mm between the worktop and the wall unit. A minimum clearance of 1000 mm is recommended for ergonomic reasons.

6.4 Cut-out dimensions

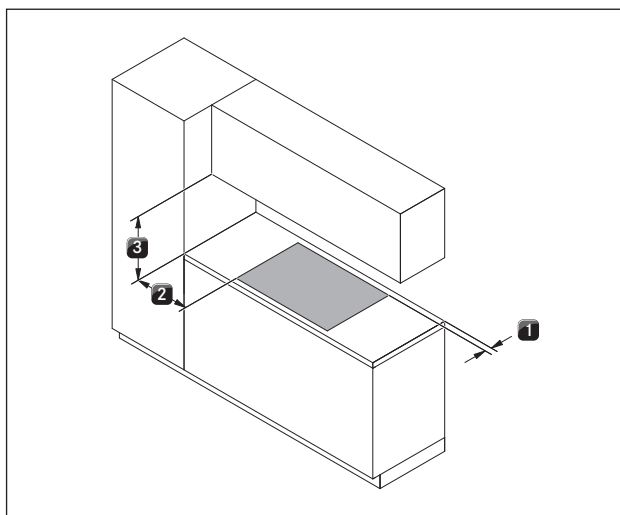
Preparing the worktop

- Create the worktop cut-out.
- Make sure that the cutting surfaces of the worktops are properly sealed.
- Comply with the worktop manufacturer's instructions.

Flush installation



Abb. 6.2 Flush installation



Abb. 6.3 Groove dimensions cut-out

INFO If the induction glass ceramic wok is used, the groove dimensions must be increased to 7 mm for flush installation.

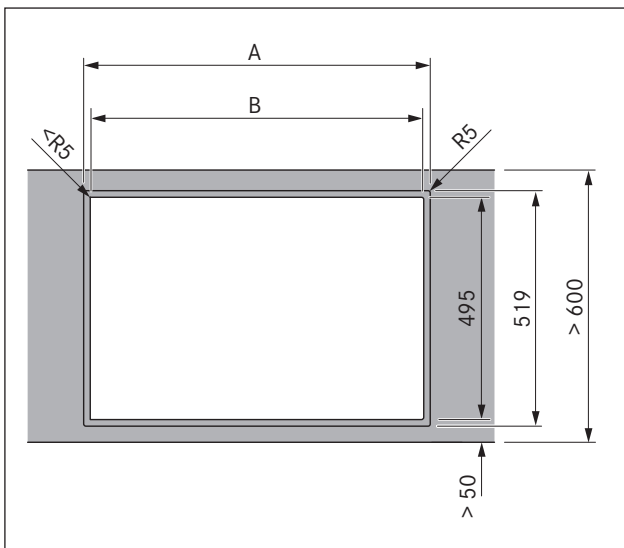
Surface mounting

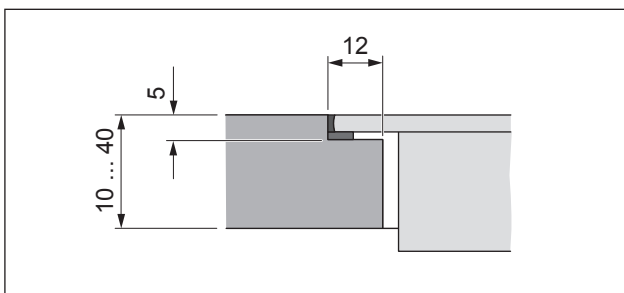

Abb. 6.4 Surface mounting



Abb. 6.5 Surface mounting cut-out

Cut-out dimensions when installing cooktops only or cooktops and the BORA cooktop extractor alongside each other:

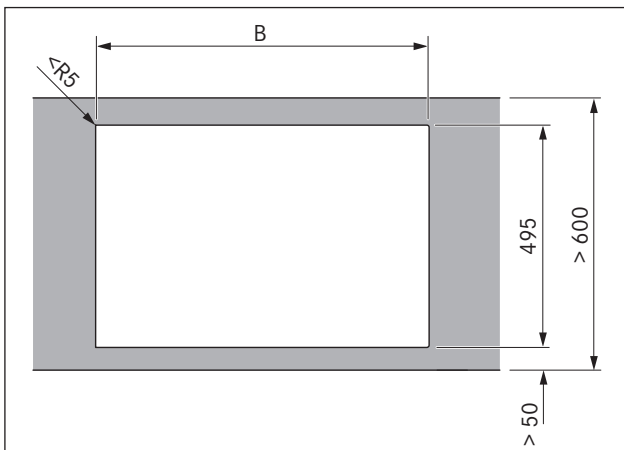
Cooktops/cooktop extractor	A in mm	B in mm	
	1/0	344	320
	2/0	685	661
	3/0	1026	1002
	2/1	776	752
	3/2	1208	1184
	4/2	1549	1525

Tab. 6.2 Cut-out dimensions

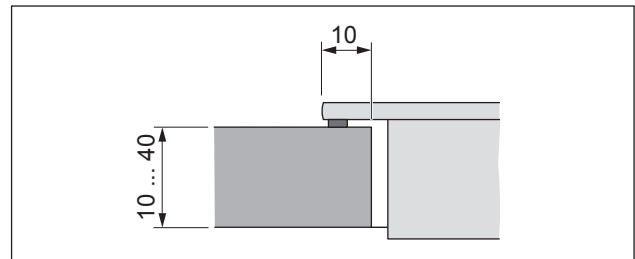
Attaching the sealing tape



Abb. 6.6 Sealing tape with flush installation

- [1] Black, heat-resistant silicone sealant
- [2] Sealing tape

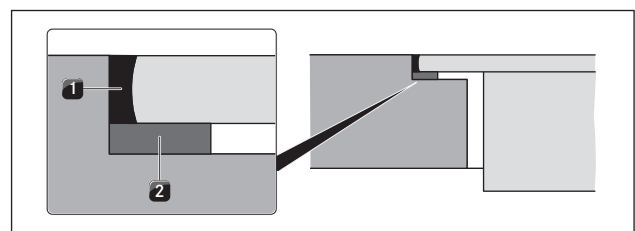

Abb. 6.7 Sealing tape with surface mounting

- [1] Black, heat-resistant silicone sealant
- [2] Sealing tape

- ▶ With surface mounting, attach the enclosed sealing tape [2] to the underside of the device before installing it. Do not leave any gaps.
- ▶ With flush installation, attach the enclosed sealing tape to the horizontal cutting edge in the worktop cut-out, even if you seal the cooktop with a silicone sealant [1] or similar.
- ▶ Stick the supplied nameplate (adhesive label) to the back of your operating and installation instructions.

6.5 Installing the extraction system

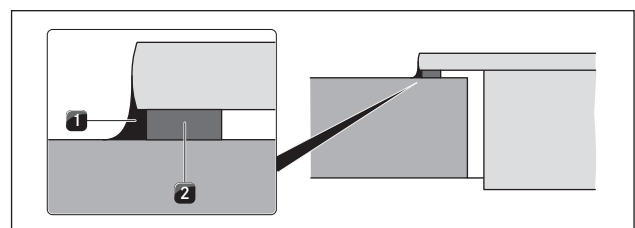
INFO Clearance of one millimetre should be planned between the built-in appliances.

INFO A clearance of two millimetres should be planned around the built-in appliances.

INFO Cable protection (false floor) should be mounted below the appliances. This needs to be removable for maintenance work.



Abb. 6.8 Side view of the cable protection and ventilation

- Cross bars on the kitchen unit in the area of the worktop cut-out may need to be removed.
- The drawers and/or shelves in the floor unit must be removable for maintenance and cleaning purposes.
- There must be a return flow aperture of $> 500 \text{ cm}^2$ in the plinth area for recirculation.

Installation dimensions

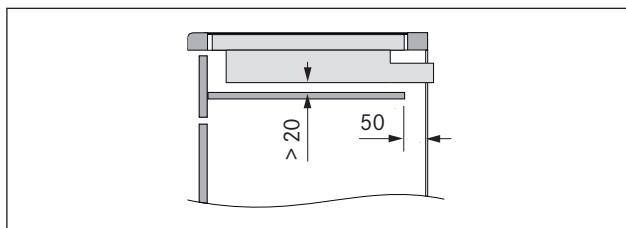

Abb. 6.9 Device dimensions with curved transition piece



Abb. 6.10 Offset with transition pieces

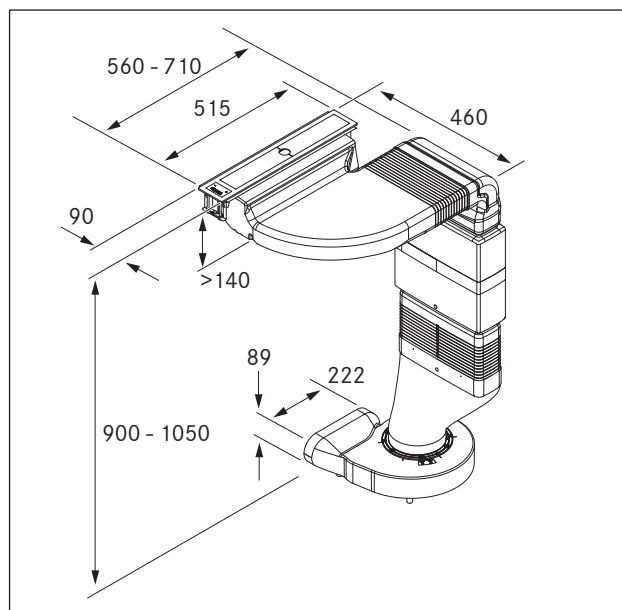

Abb. 6.11 Control unit installation dimensions

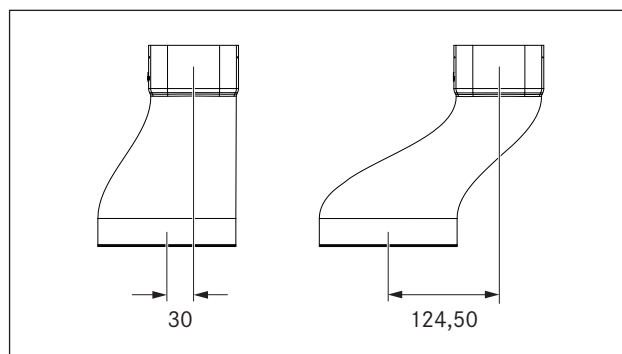

Abb. 6.12 Device installation dimensions

6.5.1 Installing the cooktop extractor

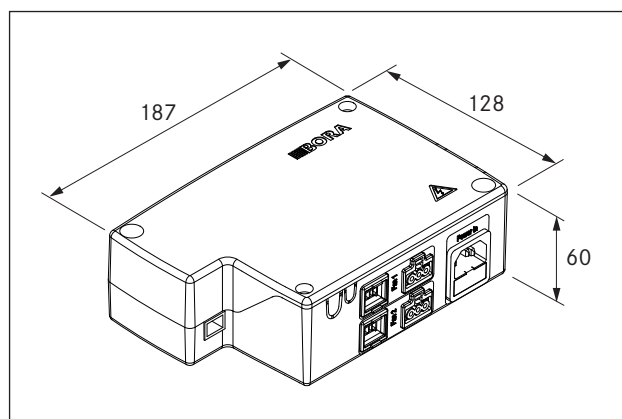
Preparing the cooktop extractor frame for installation in conjunction with the induction glass ceramic wok

INFO To install the induction glass ceramic wok, the rail on the left hand side of the cooktop extractor frame must be removed due to the 6 mm thick glass ceramic.

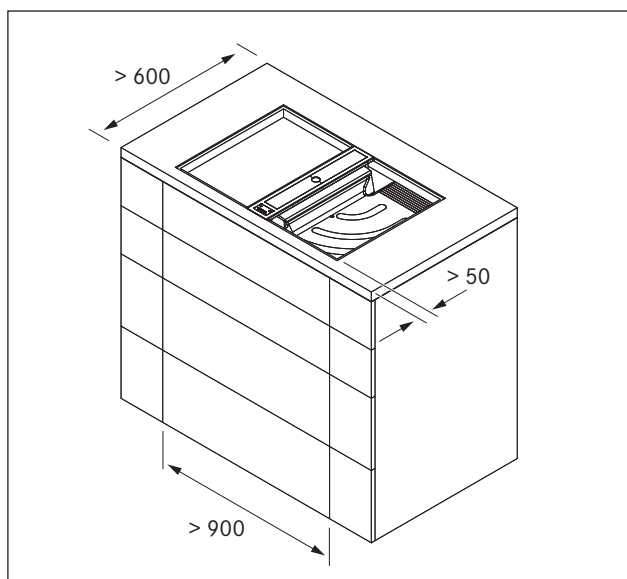

Abb. 6.13 Preparing the cooktop extractor frame

- [1] Cooktop extractor frame
- [2] Left hand side rail

- ▶ Use a pair of pliers to remove the rail from the left hand side of the cooktop extractor frame by carefully bending it up and down.

Installing the cooktop extractor frame

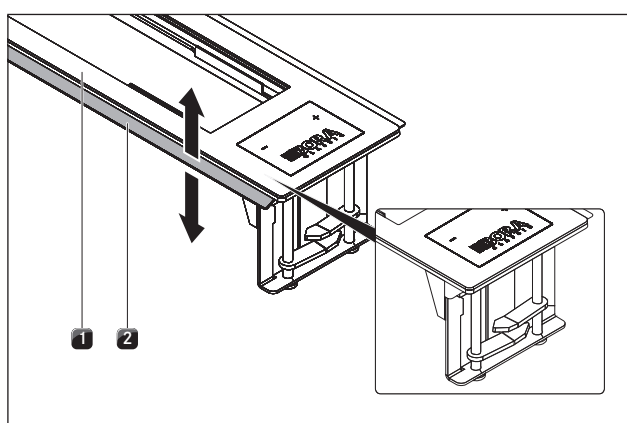
INFO The cooktop extractor's substructure module can only be installed sloping down to the right.



Abb. 6.14 Installing the cooktop extractor

- [1] Cooktop cut-out
- [2] Cooktop extractor frame

- ▶ Insert the cooktop extractor frame [2] in the middle of the relevant worktop cut-out.
- ▶ Precisely position the cooktop extractor.

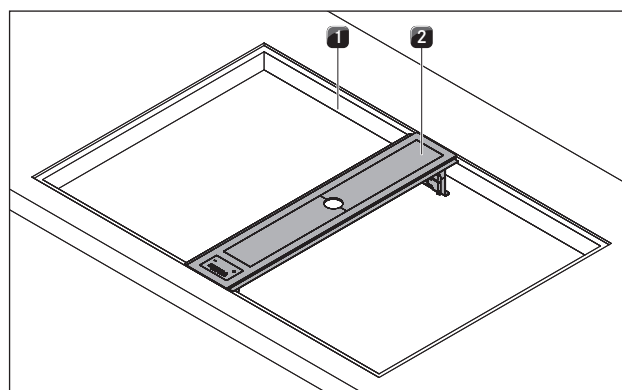

Abb. 6.15 Height adjustment plates

- [1] Height adjustment plate
- [2] Cooktop extractor frame

- ▶ If applicable, insert the height adjustment plates [1].

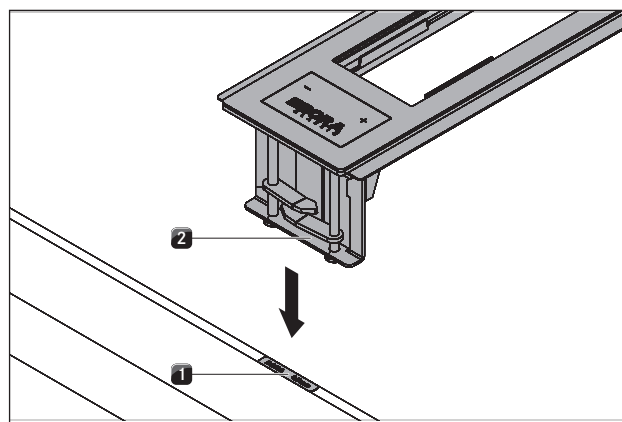

Abb. 6.16 Securing the cooktop extractor

- [1] Tensioning screw
[2] Clamp

- ▶ Turn the four clamps [2] under the worktop.
- ▶ Tighten the clamp screws [1] with max. 10 Nm.
- ▶ Check that the cooktop extractor frame is positioned correctly.
- ▶ Once all of the installation work is complete, seal the devices with black, heat-resistant silicone sealant.

6.5.2 Preparing to install the substructure module, silence module and plinth fan

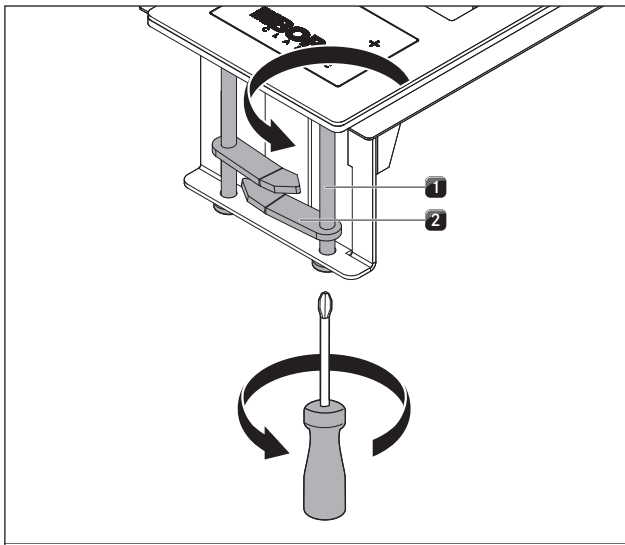
INFO The floor unit must not be supported on the plinth fan housing.

INFO For correct installation, the slide-in units of the base cabinet must be shortened depending on the installation situation.

INFO The plinth fan must only be installed horizontally.

- ▶ Now adapt the cooktop extractor system to the worktop height by shortening the silence module at the cut marks using a fine saw.



Abb. 6.17 Shortening the silence module

- [1] Silence module
[2] Cut marks
[3] Fine saw

- ▶ Now place the (curved or straight) transition piece and the silence module together on the plinth fan.

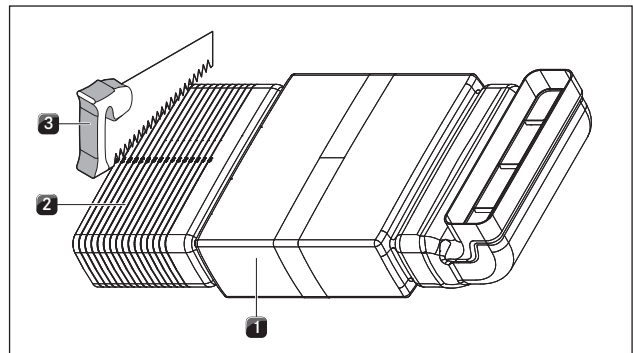

Abb. 6.18 Assembly

- [1] Protective grid
[2] Silence module
[3] Transition piece (curved or straight)
[4] Universal plinth fan inlet nozzle
[5] Universal plinth fan

- ▶ Saw out the necessary cut-outs for the ducting in the rear panel of the floor unit.
- ▶ Depending on the installation situation, adjust the levelling feet on the floor unit as necessary.
- ▶ Now adapt the substructure module to the available depth of the worktop by shortening the substructure module at the cut marks using a fine saw.

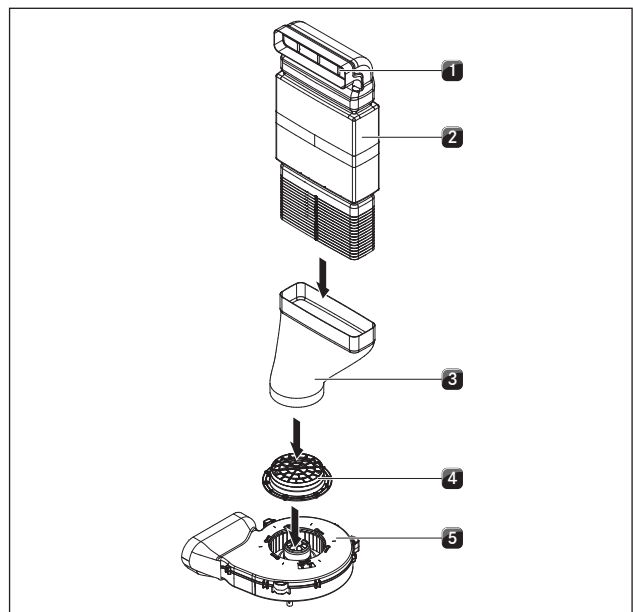

Abb. 6.19 Shortening the substructure module

- [1] Substructure module
- [2] Cut marks
- [3] Fine saw

- ▶ Prepare the plinth fan by attaching the sealing tape depending on the installation situation.
- ▶ Secure the sealing tape to the inlet nozzle.

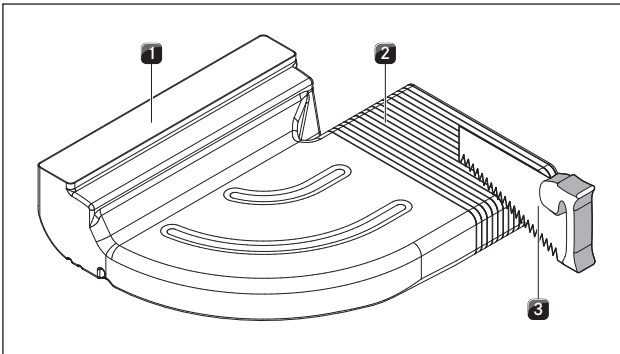

Abb. 6.20 Sealing tape position for installation with a round duct

- ▶ Secure the sealing tape on the outlet nozzle.

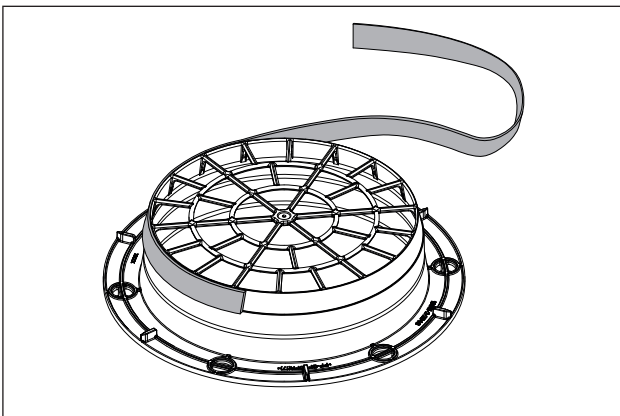

Abb. 6.21 Sealing tape position for installation with a transition piece (shallow duct)

INFO When attaching the sealing tape, ensure that an airtight seal with the connection duct piece is created when the tape is compressed.

6.5.3 Installation – standard set-up

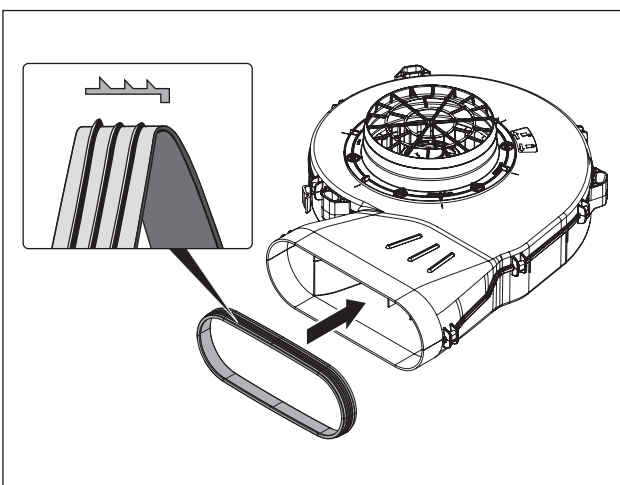

Abb. 6.22 Standard set-up

- [1] Cooktop extractor
- [2] Substructure module
- [3] Silence module
- [4] Transition piece (curved or straight)
- [5] Universal plinth fan
- [6] Air duct or recirculation unit
- [7] Protective grid (not visible)
- [8] Control unit

- ▶ Position the plinth fan [5].
- To facilitate positioning, the inlet nozzle on the plinth fan can be removed. To do this, please see the assembly instructions for the ULS universal plinth fan.
- ▶ Push the transition piece [4] onto the inlet nozzle of the plinth fan [5].
- You can also use the sealing tape provided (UDB) to adhere the connections together.
- ▶ Push the silence module [3] onto the transition piece [4].
- ▶ Tape the transition piece [4] to the silence module [3].

INFO To secure the silence module, this must be screwed to the transition piece to relieve the strain on the substructure module.

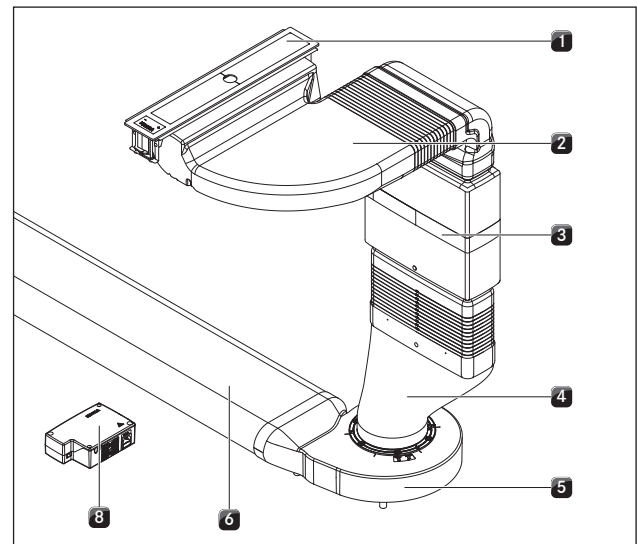
- ▶ Now screw together the silence module [3] and the transition piece [4].
- ▶ Insert the protective grid [7] into the upper opening on the silence module [3].
- ▶ Push the substructure module [2] into the silence module [3].

INFO Never place strain on the cooktop extractor frame when installing the substructure module. This will deform the cooktop extractor frame.

- ▶ Connect the substructure module [2] to the cooktop extractor frame [1] by carefully pressing the substructure module [2] upwards into the relevant cooktop extractor frame brackets [1]. The module should audibly click into place on each of the long sides of the extractor frame to indicate that it has been correctly connected.



Abb. 6.23 Attaching the substructure module

- ▶ Use the sealing tape (UDB) provided to adhere the substructure module [2] to the silence module [3].
- ▶ Place the control unit [8] in the plinth area.

INFO Position the plinth fan and the control unit in such a way that they are easily accessible and removable for maintenance work.

- The maximum exhaust air duct length is 6 m.
- The minimum cross-section of the air ducts must be 176 cm². This corresponds to a round pipe with a diameter of 150 mm.
- For the ducting, only use stable duct elements with smooth pipe interiors. Do not use flexible or fabric tubes.
- The exhaust air must be directed outside or to the recirculation unit through appropriate ducts.
- For further planning examples and notices, please see the ventilation handbook (not included in the scope of delivery).

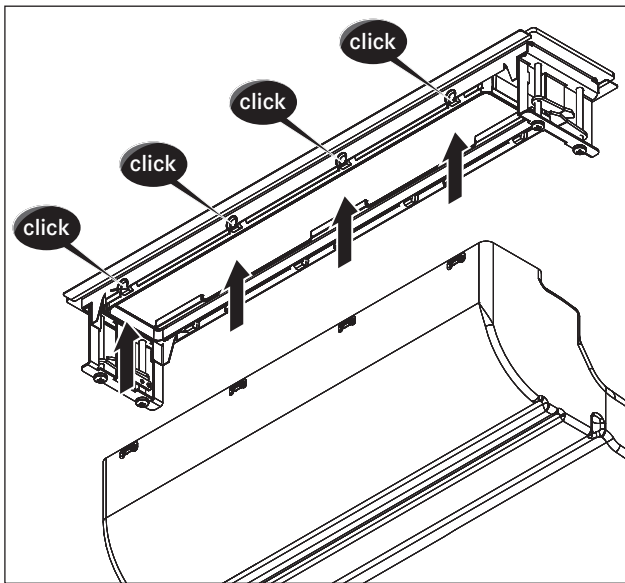
Installing the additional fan

- ▶ Install the additional fan in the exhaust duct.
- ▶ Ensure that a minimum clearance of 300 cm is maintained between the fan units.
- ▶ Only use BORA universal fans with your BORA cooktop extractor system.

Operating the cooktop extractor with a fireplace that depends on the air in the room

INFO National and regional laws and regulations must be observed with regard to the exhaust duct design. A sufficient air supply must be ensured.

Fireplaces that depend on the air in the room (e.g. gas, oil, wood or coal-fired heaters, continuous-flow water heaters, instantaneous water heaters) draw in air from the room in which they are installed and release the exhaust fumes into the outside air via an exhaust system (e.g. chimney).

If the cooktop extractor is used in exhaust mode, it draws in air from the room in which it is installed as well as from neighbouring rooms. If the air supply is insufficient, low pressure will occur. Toxic gases could be drawn out of the chimney or extraction ducting and back into the room.



Abb. 6.24 Exhaust air installation – not permitted



Abb. 6.25 Exhaust air installation – correct

- ▶ If simultaneously operating both a fireplace and the cooktop extractor in the same room, ensure that:
 - the maximum low pressure is 4 Pa (4 x 10⁻⁵ bar);
 - a safety device (e.g. window contact switch, low pressure warning device) is used to ensure that a sufficient supply of fresh air is guaranteed;
 - the exhaust air is not be ducted into a chimney that is used for exhaust gases of devices operated with gas or other combustibles;
 - the installation is checked and approved by an authorised certified engineer (e.g. heating engineer).

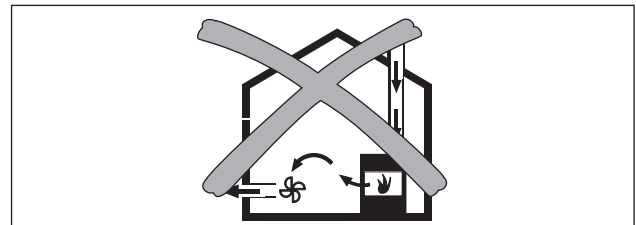
6.6 Establishing the power connection and communication

- ▶ Observe all safety and warning information (see the Safety section).
- ▶ Observe all national and regional laws and regulations as well as the supplementary regulations of the local utility companies.
- The plug for the power supply must be accessible following installation.
- If the power supply cable has been damaged this must be replaced.

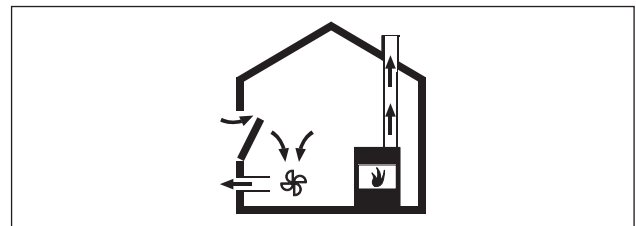
Connecting the control unit and fan to the cooktop extractor



Abb. 6.26 Connections on the control unit

- [1] CAT 5 communication cable
- [2] Home Out
- [3] Home In
- [4] Fan 1 control line
- [5] Fan 2 control line
- [6] Fan 1 power supply cable
- [7] Fan 2 power supply cable
- [8] Power supply cable with microfuse

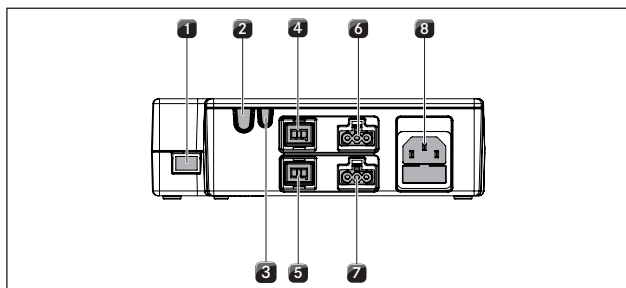

Abb. 6.27 CAT 5 communication cable connection

- ▶ Connect the CAT 5 communication cable between the cooktop extractor connection [1] and the control unit [1].

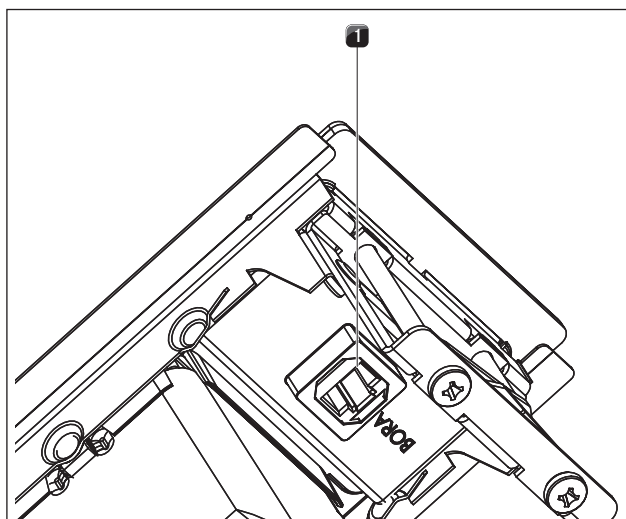

Abb. 6.28 Connection plug for the plinth fan

- [1] Connection plug for the plinth fan control line
- [2] Connection plug for the plinth fan power supply cable

- ▶ Connect the plinth fan's control line [1] to the control unit [4].
- ▶ Connect the plinth fan's power supply cable [2] to the control unit [6].

Release the power supply cable

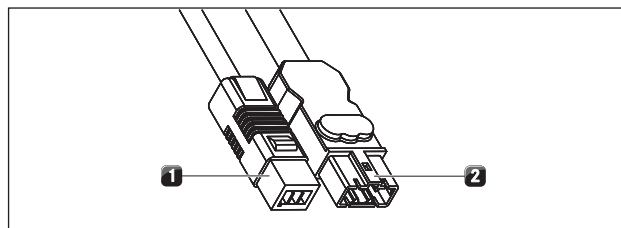
To release the power supply cable [2] from the control unit [6] you need a small flathead screwdriver.

- ▶ Disconnect the control unit's power supply cable from the power supply [8].
- ▶ Make sure that there is no power to the appliance.
- ▶ Use the flathead screwdriver to loosen the lock on the power supply cable's plug.
- ▶ To do this, insert the flathead screwdriver into the gap in the socket.
- ▶ Press the lock down gently.
- ▶ Use the flathead screwdriver to gently lever the power supply cable's plug out of the control unit's socket.
- ▶ Now disconnect the power supply cable from the socket.
- ▶ Check the plug and the socket for damage.
- ▶ Do not use damaged components.
- ▶ Contact your BORA specialist supplier to replace any damaged components.

Connecting an additional fan

- ▶ Connect the fan's control line [1] to the control unit [5].
- ▶ Connect the fan's power supply cable [2] to the control unit [7].
- ▶ Check all the plug connections to ensure that they are secure.

6.7 Connecting external switch contacts

INFO The Home In and Home Out communication connections must only be connected by a certified specialist. The specialist also assumes responsibility for the proper installation and commissioning.

When using Home In and Home Out, you will require the relevant documents for the external switching devices in order to ensure safe device connection and operation.

The following switch contacts can be used:

Contact	Function	Connection
Home In	Cooktop extractor on/off connection for external switch contact (contact closed: cooktop extractor on)	24V DC 100 mA
Home Out	Electrically isolated contact for controlling external devices depending on the operating status of the cooktop extractor (cooktop extractor on: contact closed)	Maximum 250 VAC/ 30 VDC, 2.5 A

Tab. 6.3 Switch contacts

INFO The Home In contact can be used for external safety devices (e.g. window contact switches). If the switch is open, the cooktop extractor is out of operation.

- ▶ Ensure that the control unit is disconnected from the power supply.

Preparing the universal control unit

- ▶ Remove the screws from the control unit.
- ▶ Lift up the cover.



Abb. 6.29 Open the control unit's cover

- [1] Cover
- [2] Electronic unit
- [3] Base unit
- [4] Switch contact clamp

INFO The electronic unit [2] can contain residual charge. You must therefore be careful not to touch the exposed contacts on the electronic unit!

Preparing connection cables for external switching devices

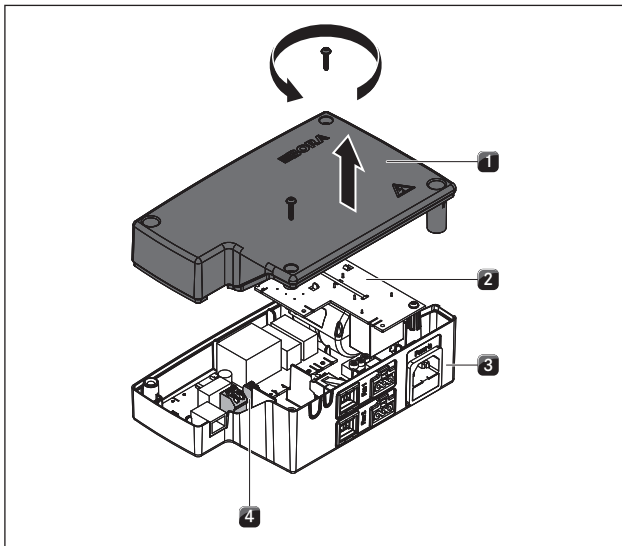
Use connection cables of the following types and from the following manufacturer to connect external switching devices.

Contact	Connection cable
Home In	H03VV-F 2x0.5mm ²
Home Out	H03VVH2-F 2x0.75mm ²

Tab. 6.4 Connection cable

INFO The connection cable is only designed for indoor use in buildings, private households, kitchens or offices!

INFO The overall length of the connection cable for external switching devices must not exceed 10 m!

For reasons of electromagnetic compatibility, all connection cables from external switching devices must be filtered with a ferrite sleeve. This is not included in the scope of delivery.

- ▶ Use the order code UFH (universal filter sleeve) to order the filter sleeve from your specialist supplier or contact BORA via the website at www.bora.com.



Abb. 6.30 Wrap the connection cable around the ferrite sleeve three times

- ▶ Wrap the connection cable around the ferrite sleeve three times to create the desired filter performance.
- ▶ Ensure that the cable end protrudes at least 120 mm from the sleeve.
- ▶ Prepare the connection cable in accordance with the prescribed stripping lengths.

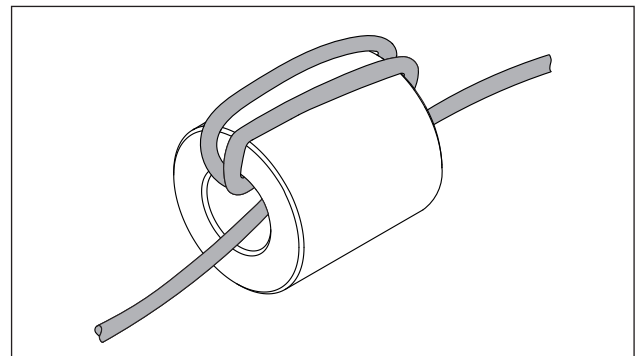

Abb. 6.31 Stripping lengths and assembly position of the connection cable in the control unit

- [1] Stripped wire end
- [2] Insulated wire
- [3] Jacketed cable
- [4] Strain relief clamp
- [5] Cable feed snap-out element
- [6] Universal ferrite sleeve (UFH)

- Please adhere to the maximum stripping length of 9 mm on the stripped wire end [1].
- Please adhere to the maximum stripping length of 26 mm on the insulated wire [2].

Installing the external switching device

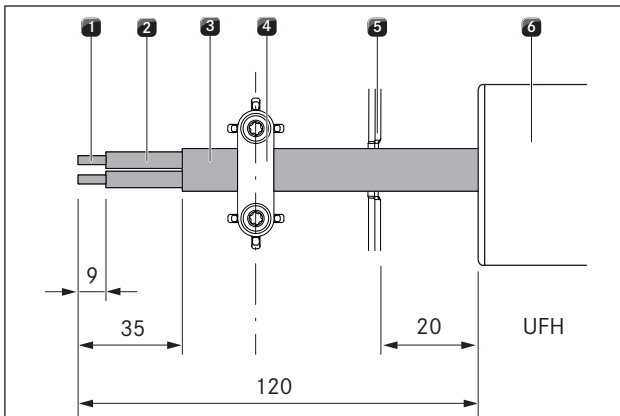
Depending on the type of switching device, connect the connection cables to either the Home In or the Home Out connection clamp.

- ▶ Adhere to the connection diagram when connecting Home In and Home Out.



Abb. 6.32 Connection diagram for the external switch contacts

- ▶ Connect the cable for the relevant contact to the switch contact clamp [4] in accordance with the relevant connection diagram (see fig. Connection diagram for the external switch contacts).
- In order to connect the Home In interface, the installed bridge must be removed.

INFO The Home In contact must be bridged if this is not used (bridged on delivery).

- For connections to the Home In connection clamp, no ferrules may be used.
- ▶ Clamp the connection cable in the strain relief clamp [4] in accordance with the wire cross section used.

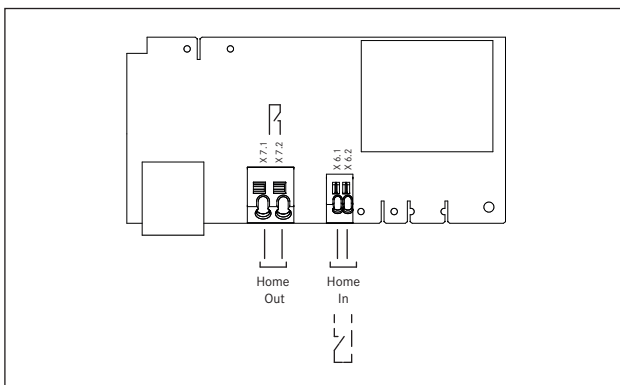
INFO If external switching devices are connected both to the Home In and Home Out interfaces, both cables should be secured with the strain relief clamp [4].

- ▶ Remove the relevant snap-out element [2] in the plastic housing of the control unit.



Abb. 6.33 Home Out contacts with strain relief

- [1] Strain relief clamp
- [2] Snap-out element for cable feed

- ▶ Check that the connection cables have been correctly installed and securely connected.
- ▶ Close the cover on the control unit.
- ▶ Make sure that the cable is not damaged.
- ▶ Switch on the main switch/automatic circuit breaker.

Establishing the power connection

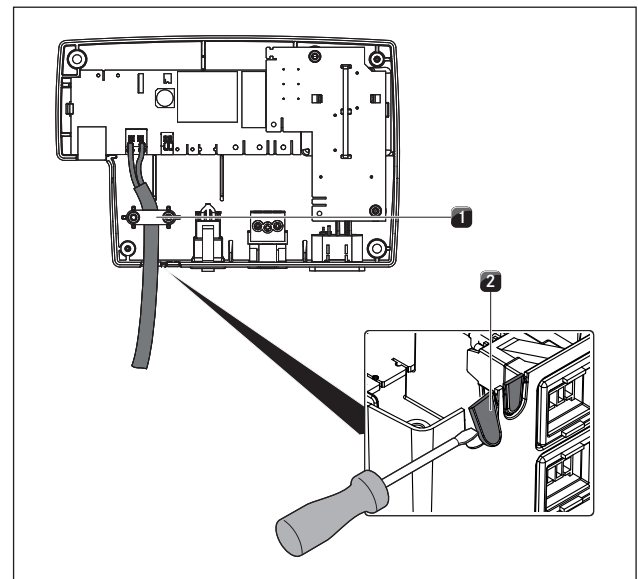
- ▶ Connect the power supply cable for the control unit to the power supply.
- ▶ Put the cooktop extractor into operation (see the Operation section).
- ▶ Check that all the functions are working correctly.

6.8 Handover to user

Once installation is complete:

- ▶ Explain the main functions to the user.
- ▶ Explain all safety-related aspects of operation and handling to the user.
- ▶ Provide the user with the accessories and operating and installation instructions for safe storage.

7 Operation

- ▶ Observe all safety and warning information during operation (see the Safety section).

INFO The cooktop extractor should only be operated with BORA cooktops.

INFO Only switch on the cooktop extractor if one of the two cover plates is open.

INFO The cooktop extractor should only be operated when the stainless steel grease filter is installed.

INFO When using two gas cooktops, we recommend using two additional cover plates. You can obtain these from your specialist supplier or by contacting BORA via the website www.bora.com.

7.1 Operating the cooktop extractor

Recommendations for efficient vapour extraction

- ▶ Always use a lid on pots, particularly those that are high. This ensures effective vapour extraction. It also reduces power consumption.
- ▶ Only operate the cooktop extractor at the minimum power level required for effective vapour extraction. This makes it possible to improve the performance of the odour filters in recirculation mode.
- ▶ Only operate the hob at the minimum power level required for cooking. This reduces cooking vapours and power consumption.
- ▶ Avoid strong drafts.

7.1.1 Opening the cover plates



Abb. 7.1 Using the cover plates

[1] Cover plates

[2] Cooktop extractor frame

- ▶ Remove the cover plates [1] from the cooktop extractor frame [2].
- ▶ Store the cover plates in the side guide groove on the cooktop extractor frame.
- ▶ When using multiple hobs, remove the cover plates from the cooktop extractor frame.
- ▶ When using a gas cooktop, use the cover plates as an air baffle to prevent any burner flame delay.
- ▶ For this purpose, insert the cover plates into the side guide groove on the side of the cooktop extractor frame facing the gas cooktop.

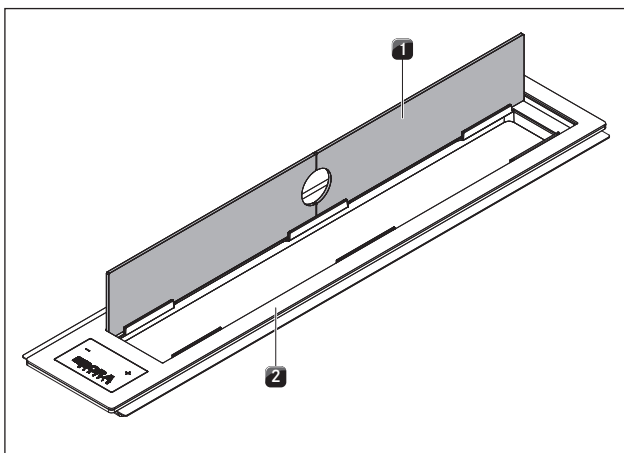
Switching on

- ▶ Use your finger to press the **+** or **-** button for approx. 2 seconds to switch on the cooktop extractor.

□ is shown in the fan display. In case of no further input, the cooktop extractor will switch off automatically after about 10 seconds.

Switching off

- ▶ Use your finger to press the **+** or **-** button to switch off the cooktop extractor.
- ▶ Press and hold the **+** or **-** button to automatically scroll through the power levels.
- ▶ Press **+** or **-** several times until the fan indicator □ is displayed.
- If the fan indicator displays □, the cooktop extractor is switched off automatically after 5 seconds.

7.1.2 Adjusting the power level

- ▶ Press **+** to increase the power level from level 1 to level 5.
- ▶ Press **-** to reduce the power level from level 5 to level 0.

7.1.3 Automatic after-run

Activation

- ▶ Press the **-** button until the power level *n* is displayed for automatic after-run.
- ▶ While the device is on, simultaneously press the **+** and **-** buttons until the automatic after-run *n* is displayed.
- The cooktop extractor switches off automatically after 20 minutes.

Early deactivation

- ▶ Press the **-** button until the fan indicator □ is displayed.

7.2 Pay attention to the filter service display

If F appears on the fan display, this means the service life of the activated charcoal filter has expired (with recirculation only) and the stainless steel grease filter needs to be thoroughly cleaned.

- ▶ Press the $+$ or $-$ button to set the desired power level and switch to the normal operating mode.

The filter service display is shown every time the cooktop extractor is switched on and remains active until the filter has been changed and the filter service display has been reset. The cooktop extractor can still be operated without limitations.

Changing the filter

- ▶ Switch off the cooktop extractor.
- ▶ Observe all the information provided in the Cleaning section.
- ▶ Replace the activated charcoal filter.
- ▶ Clean the stainless steel grease filter.

Resetting the filter service display

If the activated charcoal filter has been replaced and the stainless steel grease filter has been cleaned, it will be necessary to reset the filter service display.

- ▶ Switch off the cooktop extractor.
- F is displayed in the fan indicator.
- ▶ Simultaneously press $+$ and $-$ for at least 5 seconds until a \square is permanently displayed in the fan indicator.
- The filter service display has been reset.
- The filter service display can only be reset if a filter service is due after 200 operating hours.

7.2.1 Closing the cover plates

- ▶ After switching off the cooktop extractor, close it with the two cover plates.

8 Cleaning and Maintenance

- ▶ Observe all safety and warning information (see the Safety section).

INFO Clean the stainless steel surfaces in the polishing direction only.

- Regular cleaning and maintenance ensures the longevity of the product and optimal function.
- ▶ Adhere to the following cleaning and maintenance cycles:

Component	Cleaning cycle
Cooktop extractor interior and surface	After cooking very greasy dishes; at least once a week
Cover plates and stainless steel grease filter	After cooking very greasy dishes; at least once a week
Activated charcoal filter (with recirculation only)	Replace if odours have built up or the service life has expired (see the operating instructions for the activated charcoal filter)

Tab. 8.1 Cleaning cycles

8.1 Cleaning agents

INFO Due to the use of aggressive cleaning agents and abrasion caused by the pot bases the surface will become damaged and dark stains will occur.

- ▶ Never use steam cleaners, abrasive sponges, scouring pads or chemically aggressive cleaning agents (e.g. oven cleaner spray).
- ▶ Make sure that the cleaning agent does not contain any sand, soda, acids, lyes or chloride.

8.2 Cleaning the cooktop extractor

Grease particles and limescale residues from cooking vapours can settle on the surface and in the extraction system.

- ▶ Make sure that the cooktop extractor is switched off (see the Operation section).
- ▶ Remove the cover plates and stainless steel grease filter prior to cleaning.
- ▶ Clean the cooktop extractor in accordance with the cleaning cycles.
- ▶ Clean the surfaces using a soft, damp cloth, detergent or a mild window cleaning agent.

- ▶ Soften dried on dirt using a damp cloth (do not scrape it off!).

8.2.1 Removing the cover plates and the stainless steel grease filter



Abb. 8.1 Removing the cover plates

- ▶ Lift the cover plates off upwards.

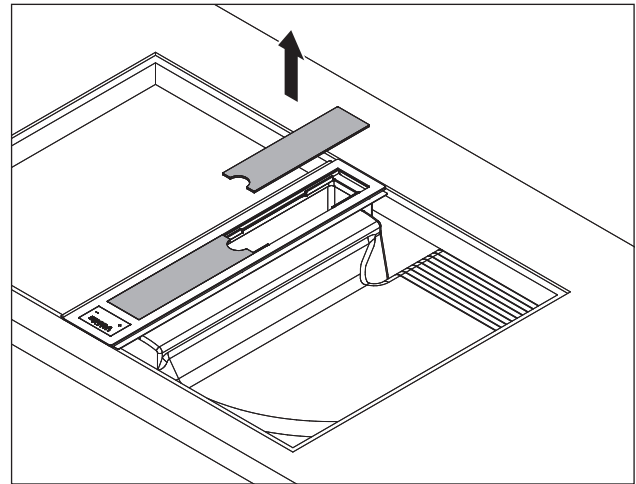

Abb. 8.2 Removing the stainless steel grease filter

- ▶ Reach into the opening in the cooktop extractor and remove the stainless steel grease filter.

8.2.2 Cleaning the cover plates and the stainless steel grease filter

- The cover plates and stainless steel grease filter can be cleaned manually or in the dishwasher.

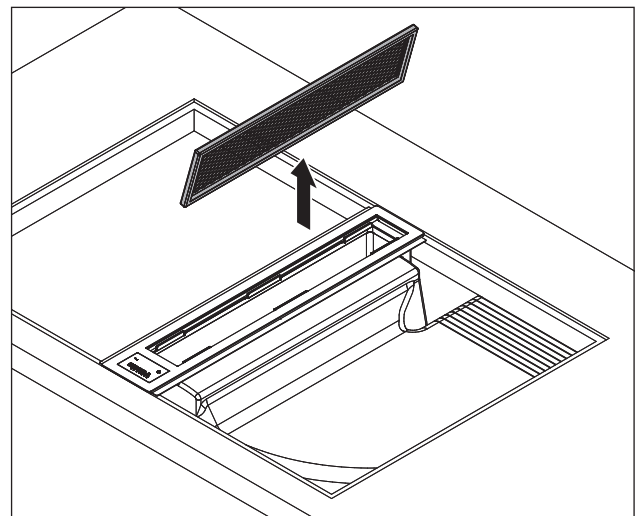
Manual cleaning

- ▶ Use a detergent with a degreasing agent.
- ▶ Rinse the cover plates and stainless steel grease filter with hot water.
- ▶ Clean the cover plates and stainless steel grease filter with a soft brush.
- ▶ Rinse the components thoroughly after cleaning.

Cleaning in the dishwasher

- ▶ Rinse the cover plates and stainless steel grease filter with a rinsing program at maximum 65 °C.
- The stainless steel grease filter absorbs the greasy particles from cooking vapours.
- If it is no longer possible to clean the stainless steel grease filter completely, it must be replaced.

8.2.3 Installing the cover plates and stainless steel grease filter



Abb. 8.3 Inserting the stainless steel grease filter

- ▶ Insert the stainless steel grease filter into the opening in the cooktop extractor.
- ▶ Ensure that the stainless steel grease filter is positioned in the gap in the cooktop extractor housing; it does not need to be locked into place.

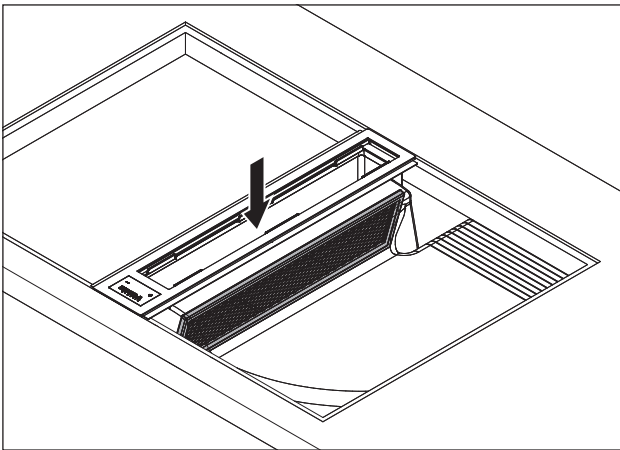

Abb. 8.4 Inserting the cover plates

- ▶ Insert the cover plates.

8.3 Replacing the activated charcoal filter

In recirculation mode, an additional activated charcoal filter is used. The activated charcoal filter absorbs cooking odours. The activated charcoal filter is installed on the plinth fan or the duct system.

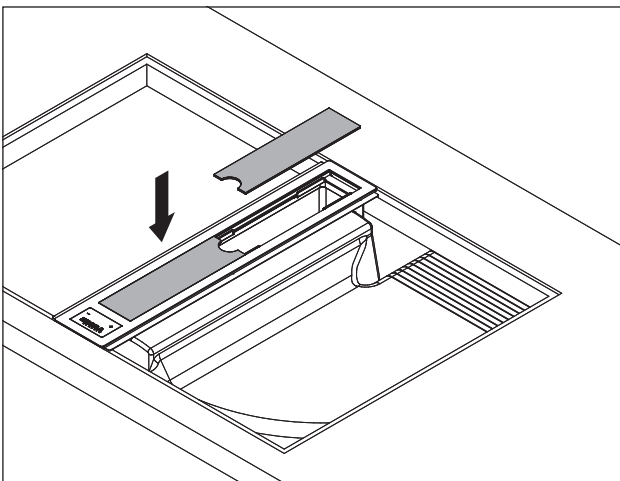
INFO Regularly replace the activated charcoal filter. The service life can be found in the operating instructions for the relevant activated charcoal filter.

INFO You can obtain activated charcoal filters from your specialist supplier or by contacting BORA via the website at www.bora.com.

- A description of how to replace the activated charcoal filter can be found in its operating instructions.
- ▶ Reset the filter service display (see the Device description section).

9 Troubleshooting

► Observe all safety and warning information (see the Safety section).

Operating situation	Cause	Remedy
The cooktop extractor cannot be switched on.	The fuse or automatic circuit breaker of the electrical wiring system in the apartment and/or house is defective.	Replace the fuse. Switch the automatic circuit breaker back on.
	The fuse or the automatic circuit breaker trips several times.	Call the BORA Service Team.
	The power supply is disconnected.	Have a specialist electrician inspect the power supply.
	The microfuse in the universal control unit's cooling device plug is defective.	Replace the fuse (type: T3, 15 A/250 V).
E flashes in the fan display for 5 seconds and the fan is switched off.	The Home-In contact is broken.	When using a window contact switch (safety device), the window must be open when the fan is operating.
	The safety device is defective.	Call the BORA Service Team.
Odours form when operating the cooktop extractor.	This is normal on brand-new appliances.	Odours stop forming after a few operating hours.
The extraction performance of the cooktop extractor has decreased.	The stainless steel grease filter is heavily soiled.	Clean or replace the stainless steel grease filter.
	The activated charcoal filter is heavily soiled (recirculation only).	Replace the activated charcoal filter.
	There is an object in the air guiding housing (e.g. cleaning cloth).	Remove the object.
	The fan is defective or a duct connection has become loose.	Call the BORA Service Team.

Tab. 9.1 Resolving a fault

► In all other instances, call the BORA Service Team (see the Warranty, service and spare parts chapter).

10 Decommissioning, disassembly and disposal

- ▶ Observe all safety and warning information (see Safety chapter).
- ▶ Follow the enclosed manufacturer's information.

10.1 Decommissioning

Decommissioning is considered the final decommissioning and disassembly. After decommissioning, the device can either be built into another piece of furniture, sold on privately, or disposed of.

INFO Disconnecting and connecting the electricity and gas connection may only be carried out by certified experts.

- ▶ Switch off the device before decommissioning (see Operating chapter)
- ▶ Disconnect the device from the voltage supply.

10.2 Disassembly

The removal requires that the device is accessible for disassembly and was separated from the voltage supply. On gas-powered devices, make sure that the gas connection is complete.

- ▶ Undo the mounting brackets.
- ▶ Remove the silicone joints.
- ▶ Disconnect the duct from the cooktop extractor.
- ▶ Remove the device from the worktop upwards.
- ▶ Remove further accessory parts.
- ▶ Remove the old appliance and dirty accessory as described under "Disposing of the product in an environmentally friendly way".

10.3 Disposing of the product in an environmentally friendly way

Disposal of transport packaging

INFO The packaging protects the device against transport damages. The packaging is made of materials that are environmentally friendly and easy to dispose of and can therefore be recycled.

Returning the packaging material into the material cycle saves resources and reduces the waste production. Your specialist supplier will take the packaging back.

- ▶ Hand the packaging to your specialist supplier or
- ▶ Dispose of the packaging properly taking into account the regional regulations.

Disposing of the old appliance



Electrical devices marked with this symbol should not be disposed of as household waste at the end of its life. They must be taken to a collection centre for recycling electrical or electronic non-heating appliances. For information, please contact your city or local authorities.

Waste electric and electronic equipment often still contains valuable materials. They do, however, also contain harmful substances that were required for their correct functioning and safety. When disposed of in the residual waste or if not handled correctly, they may cause harm to the health of people and the environment.

- ▶ Therefore do not dispose of your old appliance as household waste.
- ▶ Take the old appliance to a regional collection centre for return and recycling of electronic and electrical parts and other materials.

11 Warranty, service and spare parts

- ▶ Observe all safety and warning information (see Safety chapter).

11.1 Warranty

The warranty period shall be 2 years.

11.2 Service

BORA Service:

see reverse side of operating and assembly instructions



- ▶ In the case of faults you cannot fix yourself, contact your BORA specialist supplier or the BORA Service Team.

The After Sales Service will require the type designation and the serial number of your device (FD number). This information is provided on the nameplate or on the back of the manual as well as on the device.

11.3 Spare parts

- ▶ Only use original spare parts when making repairs.

INFO Spare parts can be obtained from your BORA dealer, the BORA online service website at www.bora.com/service or by calling the service number provided.

12 Notes:

Nameplate:

Germany::

BORA Lüftungstechnik GmbH
Rosenheimer Str. 33
83064 Raubling
Germany
T +49 (0) 8035 / 907-240
F +49 (0) 8035 / 907-249
info@bora.com
www.bora.com

Australia – New Zealand:

BORA APAC Pty Ltd
A/ 91-95 Victoria Road
Drummoyne NSW 2047
Australia
T +61 2 7900 5580
F +61 2 8076 3514
info@boraapac.com.au
www.boraapac.com.au

Austria:

BORA Vertriebs GmbH & Co KG
Prof.-Dr.-Anton-Kathrein-Straße 3
6342 Niederndorf
Österreich
T +43 (0) 5373 / 62250-0
F +43 (0) 5373 / 62250-90
mail@bora.com
www.bora.com

Europe:

BORA Holding GmbH
Prof.-Dr.-Anton-Kathrein-Straße 3
6342 Niederndorf
Austria
T +43 (0) 5373 / 62250-0
F +43 (0) 5373 / 62250-90
mail@bora.com
www.bora.com

